

## Parts:

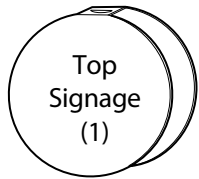

Top Signage (1)

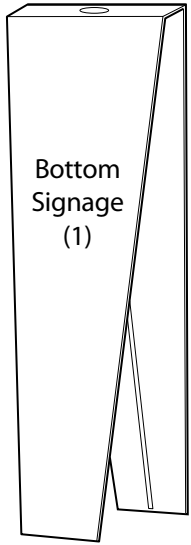

Bottom Signage (1)

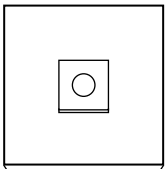

Base

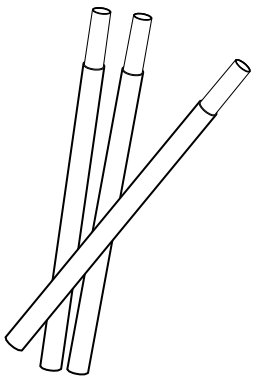

Poles (3)

## Assembly Instructions

- 1 Place base on floor** with hole side facing up.

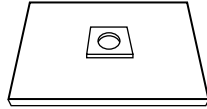

- 2 Next, connect the three pole parts together as one, and insert fully into the Base, with inner sleeve end facing up.**

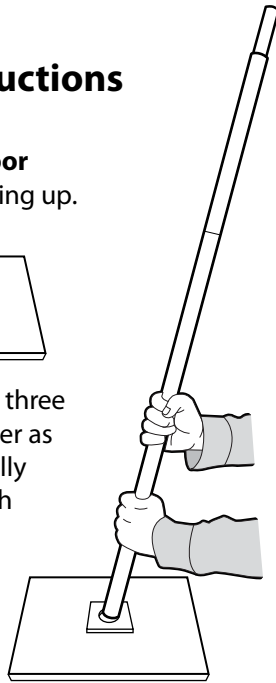

- 3 Add signage** Insert top end of pole through hole in bottom sign, leaving about a 2" space from sign bottom and top of Base.

- 4 Carefully peel off** adhesive backing of the pre-applied velcro on the inside of the signage.

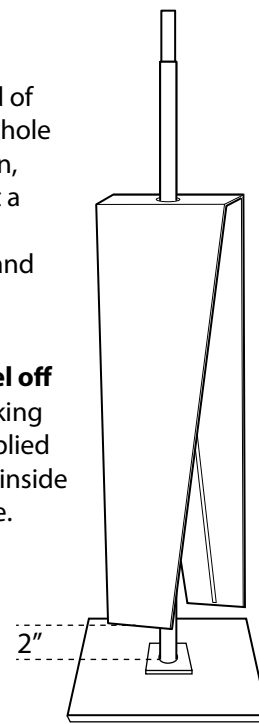

- 5 Press bottom sign into place** against pole.

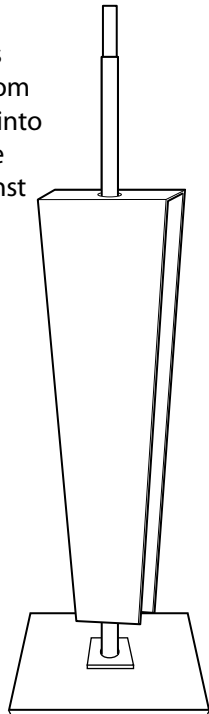

- 6 Place top sign onto top of pole - \* do NOT attempt to push pole through top sign. Instead, push the "half moon" tab down into the open end of pole.**

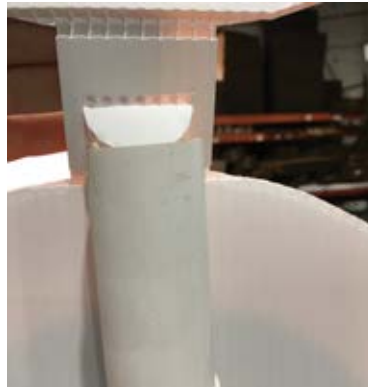

- 7 Peel off adhesive backing of the pre-applied velcro on the inside of the signage.**

- 8 Press top sign into place** against pole.

